

195-935-190 44" Side Discharge Deck (1985)
44" Side Discharge Deck

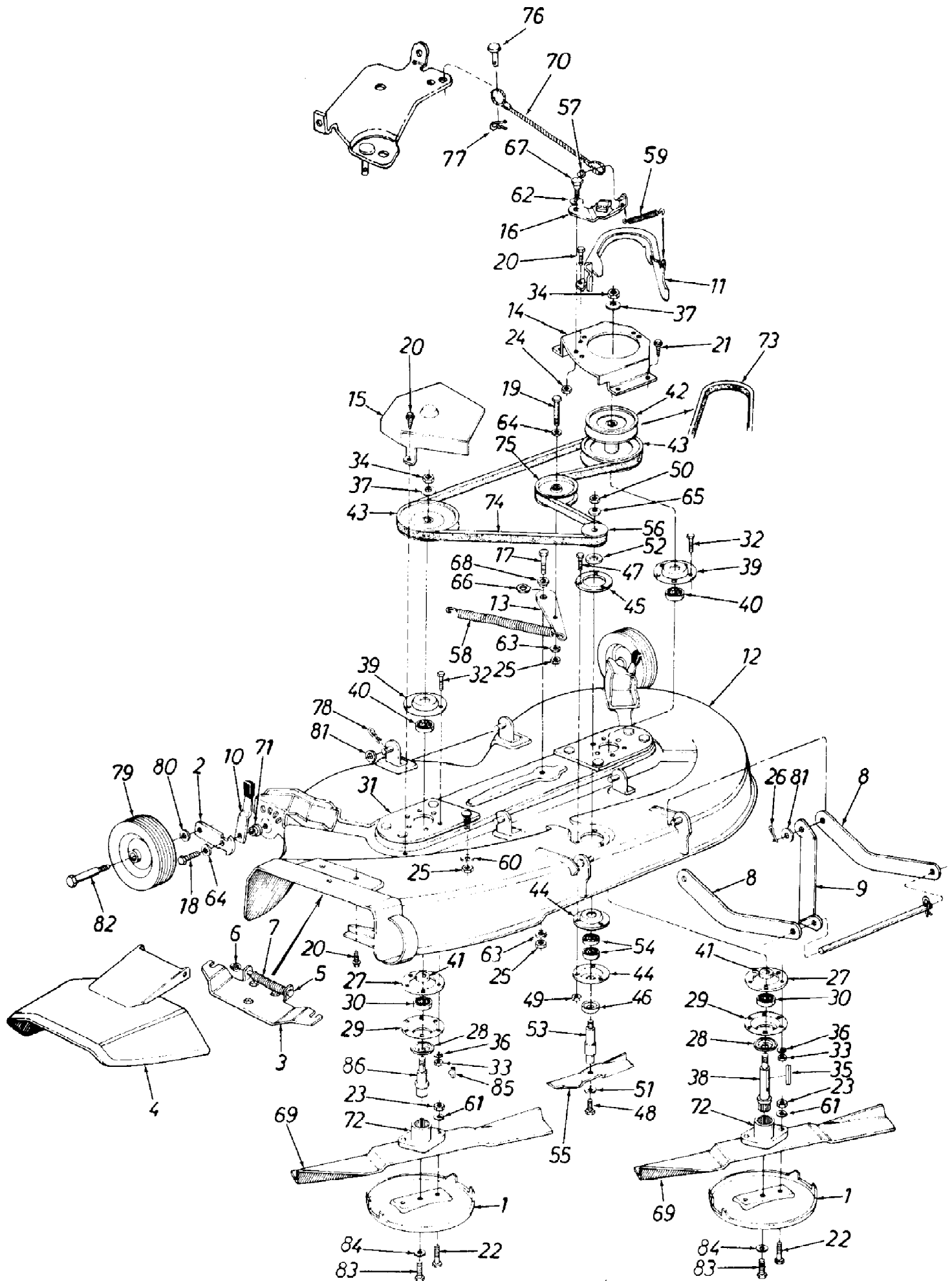

195-935-190 44" Side Discharge Deck (1985)
44" Side Discharge Deck

Page 2 of 3

Ref #	Part Number	Qty	S/P/F	Description
1	07919	1	S	Anti-Scalp Plate
2	10937	1		Wheel Pivot Bar
3	11396	1		Adapter
4	11574	1		Chute Cover Ass'y.
5	711-0571	1		Hinge Pin
6	726-0106	1	S	Cap Speed Nut 1/4" Rod.
7	732-0261	1		Torsion Spring
8	13866	1		Deck Stabilizer
9	13867	1		Diagonal Brace
10	14082	1	/P	Spring Lever Ass'y.
11	14258	1	S	Belt Guard
12	16320	1		44" Deck Ass'y.
13	16331	1		Idler Bracket
14	16333	1		Pullev Cover L.H.
15	16334	1		Pulley Cover R.H.
16	16339	1		Spindle Brake Arm Ass'y.
17	710-0152	1	S	Hex Bolt 3/8-24 x 1.00"*
18	710-0191	1	/P	Hex Bolt 3/8-24 x 1.25" Lg*
19	710-0459	1	S	Hex Bolt 3/8-24 x 1.50"*
20	710-0599	1	/P	Hex Wash. S-Tapp Scr. 1/4-20 x .50"
21	710-0726	1	/P	Hex Wash. Hd. Tapp Scr. 5/16-18 x .75" Lg.
22	710-0888	1	/P	Hex Bolt 5/16-24 x 1.0" Lg. (Special)
23	712-0123	1	/P	Hex Nut 5/16-24 Thd.*
24	712-0158	1	S	Hex Cent. L.-Nut 5/16-18 Thd.
25	712-0241	1	/P	Hex Nut 3/8-24 Thd.*
26	714-0111	1	S	Cotter Pin 3/32 Dia. x 1.00" Lg.*
27	09164	1	S	Reinforcement Plate
28	13703	1		Bearing Shield
29	15296	1	S	Open Brg. Housing 1.85 I.D.
30	741-0919	1	S	Ball Brg. .787 I.D. x 1.85 O.D. x .551
31	16349	1		Spindle Mounting Plate Ass'y.
32	710-0888	1	/P	Hex Bolt 5/16-24 x 1.0" Lg. (Special)
33	712-0123	1	/P	Hex Nut-5/16-24
34	712-0318	1	/P	Hex Jam Nut 5/8-18 Thd.
35	714-0168	1	/P	Square Key 3/16 x 2.25" Lg.
36	736-0119	1	S	L.-Wash. 5/16 I.D.*
37	736-0317	1	/P	Bell. Wash. .630 I.D. x 1.25 x .090
38	738-0632	1	S	44" Deck Blade Spindle
39	08253	1	S	Bearing Housing 1.85 I.D.
40	741-0919	1	S	Ball. Brg. .787 I.D. x 1.85 O.D. x .551
41	750-0456	1	S	Spacer 1.0 O.D. x .790 I.D. .350 Lg.
42	756-0329	1		5/8 "V"-Pulley .79 I.D. x 5.75 O.D.
43	756-0470	1	S	"V"-Pulley .791 D. x 6.50 O.D.
44	15319	1	S	1-3/8" I.D.-Bearing Housinc
45	16348	1	S	Reinforcement Plate
46	16400	1		Bearing Shield
47	710-0513	1		Hex Bolt 1/4-20 x .62" Lg.
48	710-0877	1	S	Hex Cl.-Scr. 3/8-24 x .88 Lg.
49	712-0138	1	S	Hex Nut 1/4-28 Thd.
50	712-0922	1	/P	HexJam Nut 1/2-20 Thd.
51	736-0105	1	/P	Bell.-Wash. .400 I.D. x .88 O.D. x .060
52	736-0162	1	/P	Fl.-Wash. .635 x 1.04 O.D. x .1 20"
53	738-0627	1		44" Deck Blade Spindle

195-935-190 44" Side Discharge Deck (1985)
44" Side Discharge Deck

Page 3 of 3

Ref #	Part Number	Qty	S/P/F	Description
54	741-0155	1	S	Ball Brg. .62 I.D. x 1.30" O.D. x .44"
55	742-0252	1		6.50" Blade
56	756-0468	1		1/2" V-Pulley Half .625 I.D. x 2.25" O.D.
57	726-0106	1	S	Cap Speed Nut 1/4" Rod.
58	732-0121	1	S	Extension Spring .73 O.D. x 4.31 Lg.
59	732-0465	1		Extension Spring .38 x 2.75" Lg.
60	736-0105	1	/P	Bell.-Wash. .400 I.D. x .88 O.D. x .060
61	736-0119	1	S	L.-Wash. 5/16" I.D.
62	736-0141	1	S	Spring Wash. .445 I.D. x .75 O.D. x .017
63	736-0169	1	S	L.-Wash. 3/8" I.D.
64	736-0219	1	S	Bell.-Wash. .400 I.D. x 1.13 O.D. x .030
65	736-0253	1	S	Bell.-Wash. .505 I.D. x 1.00 O.D. x .075
66	736-0174	1	/P	Spring Wash. .650 I.D. x .875 O.D. x .015 Thk.
67	738-0140	1	S	Shld. Bolt .437 Dia. x .180
68	738-0347	1	S	Shld. Spacer .625 I.D.
69	742-0295	1	S	Mower Blade 21.88
70	746-0237	1	S	Brake Cable Ass'y.
71	748-0279	1		Shld. Spacer
72	748-0300	1		Blade Adapter
73	754-0230	1	S	"V"-Belt 1/2 x 56" Lg.
74	754-0293	1	S	"V"-Belt 1/2 x 74" Lg. (Drive Belt)
75	756-0365	1	S	Fl.-Idler w/ Flanges 3.50 O.D.
76	711-0701	1	S	Clevis Pin 1/4 Dia. x .53 Lg.
77	714-0104	1	S	Intern. Cotter Pin 5/16" Dia.
78	714-0145	1	S	Intern. Cotter Pin 1/2" Dia.
79	734-0974	1	/P	Deck Wheel 6.0 x 1.38
80	736-0105	1	/P	Bell.-Wash. .400 I.D. x .88 O.D. x .060
81	736-0192	1	S	Fl.-Wash 531 I.D. x .93 O.D. x .090
82	736-0455	1		Shoulder Bolt 3/8-16 x 1.41
83	710-0877	1	S	Hex Bolt 3/8-24 x .88" Lg. (Special)
84	736-0217	1	S	L.-Washer 3/8 Heavy Duty
85	714-0122	1	S	Sq. Key 3/16 x .75" Lg.
86	738-0633	1	S	44" Deck Blade Spindle